

## Quick Installation Guide

### A: Installing the Bar Code Printer

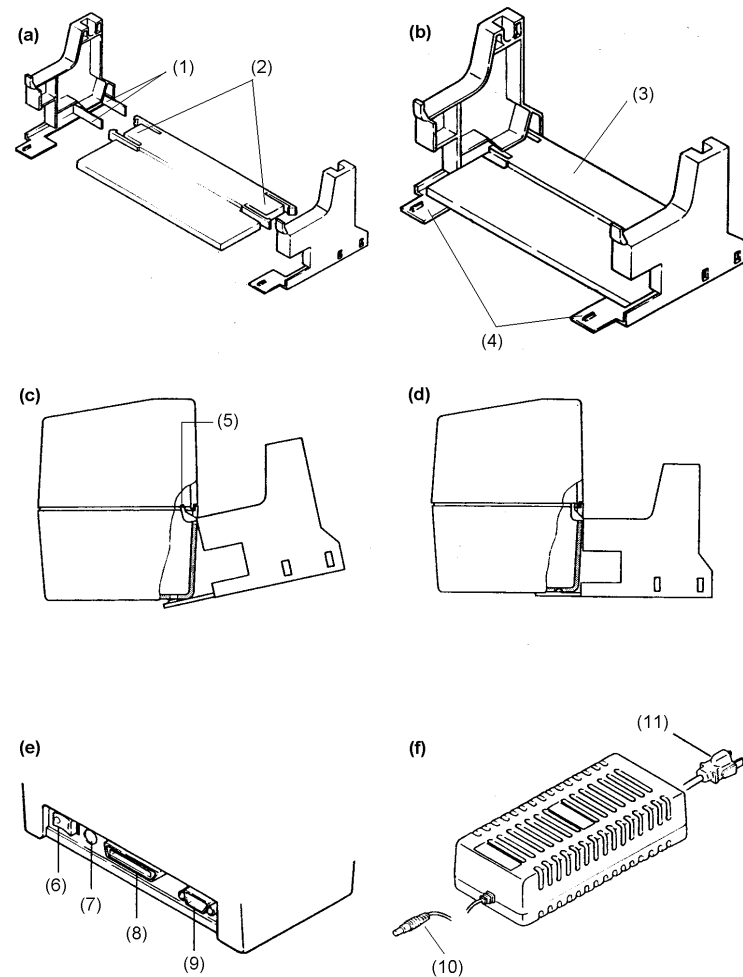

#### ● Setting Up the External Label Roll Mount

1. Insert the tenons (1) of external label roll mount supports into the slots (2) of the base plate (3) as shown in (a).
2. Make sure external label roll mount supports are tightly connected to the slots of the base plate as shown in (b).

#### ● Setting Up the Printer

1. Make sure the power is off.
2. Lay the printer on a flat table with its front surface facing down. Insert the two hooks (5) of the external label roll mount supports into the back of the printer as shown in (c). And then push down the external label roll mount until the tenons (4) of supports snap into the bottom of the printer mechanism, as shown in (d).
3. Connect the Centronics or RS-232 cable to corresponding ports (8) or (9) at the rear of the printer. Connect the other end of the cable to the computer.
4. Plug the power cord (10) into the power jack (7) at the rear of the printer, and then plug the power cable (11) into a properly grounded wall outlet.

### B: Label Loading Instructions:

1. Insert the spindle (2) into the core of the label roll.
2. With the print surface facing up, place the label roll spindle onto the slots (3) of external label roll mount supports.
3. Insert and push the label into the label insert opening (9) until it stops.
4. Hold down the **FEED** button (4) until the front edge of the label feeds about half an inch out of the printer's label dispense opening (5).
5. To use the self-peeling function, tear off the first few labels, pull label release button upwards, lead the backing paper above the the metal bar, and then insert the backing paper between the platen and self-peeling rod.

**Note: The self-peeling function is an optional device.**

6. If the label is not centered within the feeding path, open the front cover by depressing the release button (7) on the front cover. Pull the paper release button (6) to the back and hold it to adjust the label position, and then release it and close the front cover.
7. (Manually) Rewind the label roll until it is stretches tight and adjust the paper guides (8) until they are aligned with the edges of the label.
8. Press the **FEED** button until the **READY** indicator is on, and the label has been properly installed.

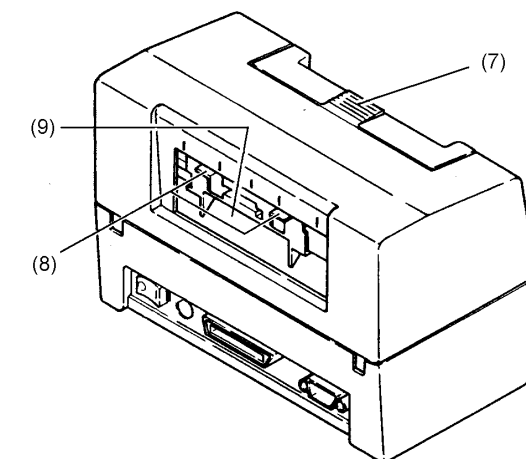
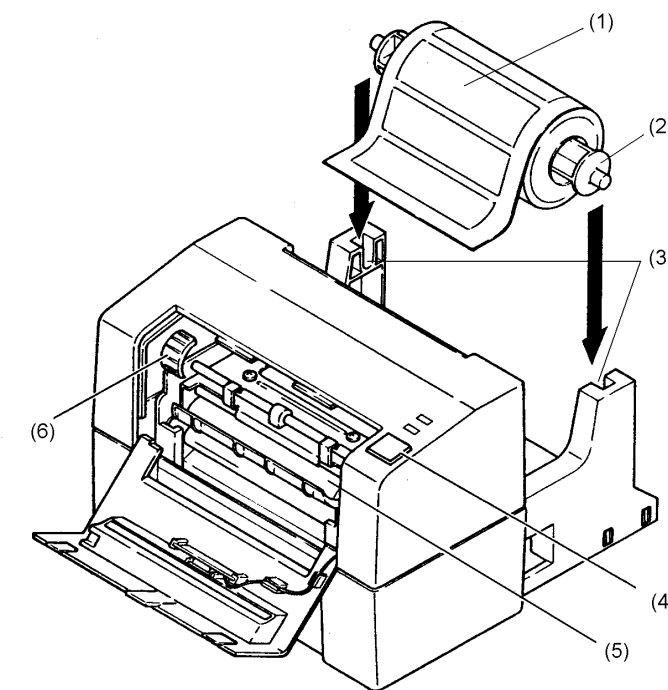

I

#### C: Power-On Utilities

##### ■ Printer Initialization

To initialize the printer, press the **FEED** button while turning on the printer. Instantly the red and green indicators will flash alternately. Press the **FEED** button again and the printer will be initialized.

For E series printers, printing parameters reset to default values whenever they are switched on.

***Note: When initialization is done, please calibrate the gap sensor again.***

##### ■ Self-Test and Gap Sensor Calibration

To initiate the self test, press the **FEED** button while turning on the printer power. Instantly the red and green LEDs will flash alternately. Release the button when this happens, wait for 10 seconds, and the printer will calibrate the label length as well as detect the gap sensor emission strength. If label gap is not detected within 7 inches, the printer stops feeding labels and the media is regarded as continuous paper.

#### D: Driver & Software Installation

For details, please refer to the readme.txt file under the Driver CD disc root directory.

For further information on printer operation, please refer to the user's manual in Driver CD disc.